



ACS-WHT-87801

SPECIFICATION DATA SHEET

PRODUCT DETAILS

Manufacturer :	Jaquar	Type:	Wall Hung Basin
Outlet	Vertical	Colour:	White
Technical Details:	Tap hole dia. $\varnothing 35 \pm 2$ mm	Material:	Ceramic - Vitreous China
	ID of waste outlet hole dia. $\varnothing 45 \pm 3$ mm Horizontal distance between the centre line of the tap hole and the centre line of the waste outlet hole ≤ 145 mm		

PRODUCT IMAGE



TECHNICAL DRAWING

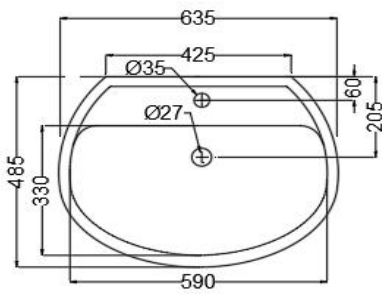

TOP VIEW

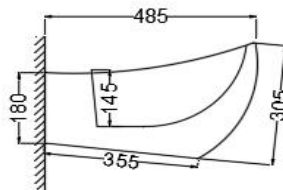

SIDE VIEW

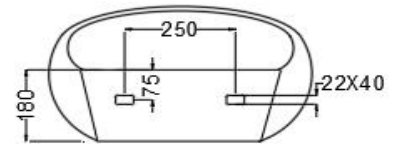

BACK VIEW

Product Dimension	635X485X305 mm	FEATURES Exclusive Design, with Tap Hole and Over Flow Hole, Anti Germ Glaze
Basin Inner Dimension	590X330X145 mm	
Product Weight	20.25 kg	

ACCESSORIES INCLUDED

Overflow hole Cap	ZPS-WHT-9012B
Rag bolt	ZPS-MST-RB03

CERTIFICATION

Compliance : EN 997 :2012+A1 2015 (E) ,MS 2578: 2014, AMD. 1: 2017, SANS 497:2011

All technical dimensions are in accordance to British standards, Bureau of Indian Standards



DISCLAIMER: Our every effort has been made to ensure factual accuracy, the information presented subject to changes due to requirements in different sites, markets and/ or countries. All dimensions are in mm (Tolerance ± 5 MM). Jaquar reserves the right to make the necessary amendments at any time without prior notice.